

CIRCUITS	A	B	C
10	2.00	4.00	5.00
12	2.50	4.50	5.50
14	3.00	5.00	6.00
16	3.50	5.50	6.50
18	4.00	6.00	7.00
20	4.50	6.50	7.50
22	5.00	7.00	8.00
24	5.50	7.50	8.50
26	6.00	8.00	9.00
28	6.50	8.50	9.50
30	7.00	9.00	10.00
32	7.50	9.50	10.50
34	8.00	10.00	11.00
36	8.50	10.50	11.50
38	9.00	11.00	12.00
40	9.50	11.50	12.50
42	10.00	12.00	13.00
44	10.50	12.50	13.50
46	11.00	13.00	14.00
48	11.50	13.50	14.50
50	12.00	14.00	15.00
52	12.50	14.50	15.50
54	13.00	15.00	15.50
56	13.50	15.50	16.50
58	14.00	16.00	17.00
60	14.50	16.50	17.50
62	15.00	17.00	18.00
64	15.80	17.80	18.80
66	16.00	18.00	19.00
68	16.50	18.80	19.50
70	17.00	19.00	20.00
72	17.50	19.80	20.50
74	18.00	20.00	21.00
76	18.80	20.80	21.80
78	19.00	21.00	22.00
80	19.80	21.80	22.80
82	20.00	22.00	23.00
84	20.80	22.80	23.80
86	21.00	23.00	24.00
88	21.80	23.80	24.80
90	22.00	24.00	25.00
92	22.50	24.50	25.50
94	23.00	25.00	26.00
96	23.50	25.50	26.50
98	24.00	26.00	27.00
100	24.50	26.50	27.50
102	25.00	27.00	28.00
104	25.50	27.50	28.50
106	26.00	28.00	29.00
108	26.50	28.50	29.50
110	27.00	29.00	30.00
112	27.50	29.50	30.50
114	28.00	30.00	31.00
116	28.50	30.50	31.50
118	29.00	31.00	32.00
120	29.50	31.50	32.50

PIW	FILM/MPAD P/N	DIM.E
10-12	KT004	4.00
14-120	KT0014	6.00
10-20	MPAD0010	4.00
22-120	MPAD0006-10	6.50

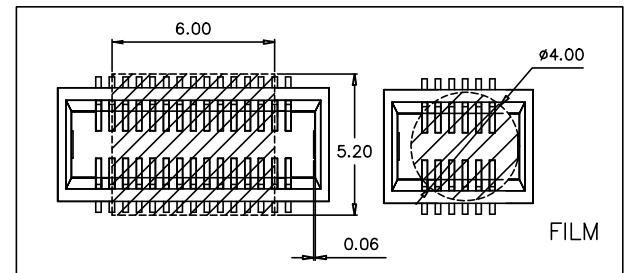
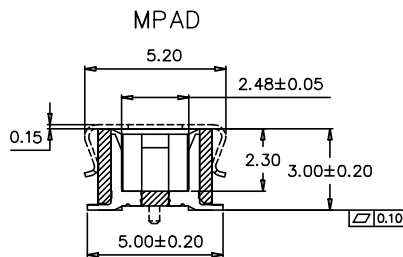
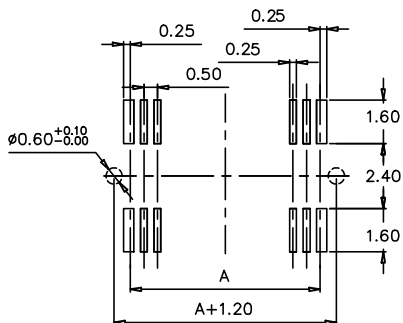
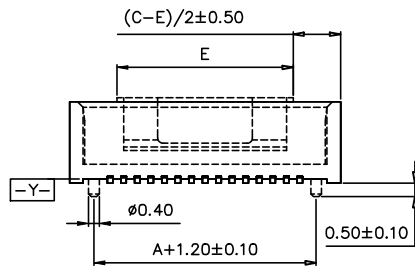
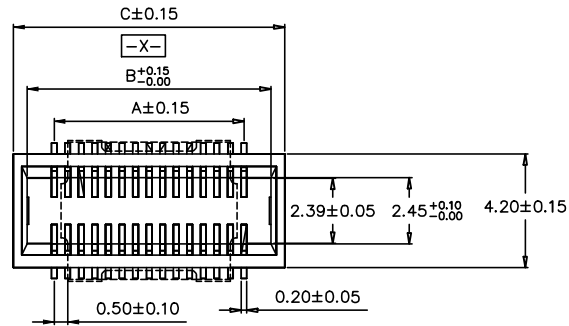

RECOMMEND P.C.B. LAYOUT
(PCB TOLERANCE ±0.05)

APTOS Technology CONFIDENTIAL
This document, and all information it contains, are the confidential, proprietary property of APTOS Technology. Disclosure, duplication or distribution of this document, or any information it contains, in whole or part, without prior written permission from APTOS Technology is strictly prohibited

SPECIFICATIONS

Current Rating: 0.5 Amps AC/DC Max.
Insulator Resistance: 100 Megohms min.
Contact Resistance: 60m ohm Max.
Dielectric withstanding: AC 500V
Durability: 30 Cycles Min.
Contact Retention: 150g Min. Per contact
Extraction Force: 11g Min Per Contact
Insertion Force: 110g Max Per Contact

MPBS1-XX XX X X-FG

S= Straight
NO. OF CONTACTS
PLATING
Definition Code

Definition	Code
Gold plated:	
flash VB	10µ" VE
	15µ" VF
	30µ" VJ
Standard:	VB

FG: RoHS Compliant
Packaging:
Null: Tube (w/o Film)
K: Reel (w/o Film)
C: Film & Reel
E: MPAD & Tube
B: MPAD & Reel
0: w/o Locating Peg
1: With Locating Peg

GENERAL TOLERANCE UNLESS OTHERWISE SPECIFIED

XXX. ± X	.XX ± 0.10
XX. ± X	.XXX ± X
X. ± 0.50	X' ± 1"
.X ± 0.30	.X' ± X"

APTOS TECHNOLOGY

REV.	A	DRAWN	09/15/09	MPBS1
DATE	09/15/09	CHECKED		0.8mm Board to Board Socket
SCALE	As shown	APPROVED		PRODUCT NO. MPBS1-XXXXXX-FG
UNIT	mm		SIZE A4	FILE NAME MPBS1-XXXXXX-FG.dwg