

P/N	DIM A	DIM B
10	2.00	3.98
12	2.50	4.48
14	3.00	4.98
16	3.50	5.48
18	4.00	5.98
20	4.50	6.48
22	5.00	6.98
24	5.50	7.48
26	6.00	7.98
28	6.50	8.48
30	7.00	8.98
32	7.50	9.48
34	8.00	9.98
36	8.50	10.48
38	9.00	10.98
40	9.50	11.48
42	10.00	11.98
44	10.50	12.48
46	11.00	12.98
48	11.50	13.48
50	12.00	13.98
52	12.50	14.48
54	13.00	14.98
56	13.50	15.48
58	14.00	15.98
60	14.50	16.48
62	15.00	16.98
64	15.50	17.48
66	16.00	17.98
68	16.50	18.48
70	17.00	18.98
72	17.50	19.48
74	18.00	19.98
76	18.50	20.48
78	19.00	20.98
80	19.50	21.48
82	20.00	21.98
84	20.50	22.48

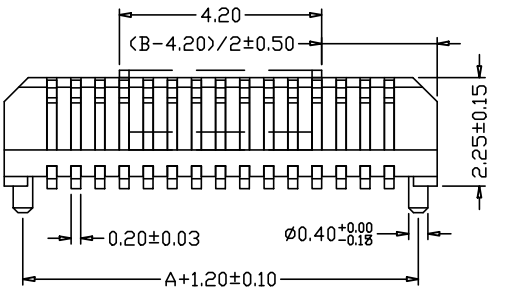

MPAD

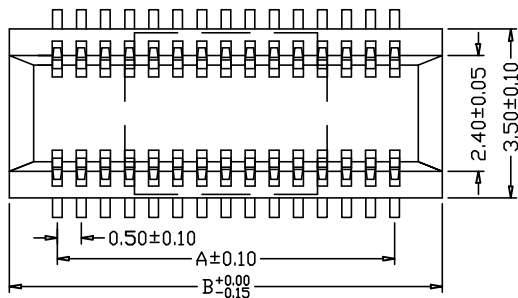
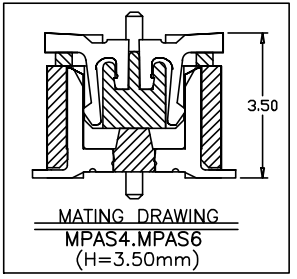
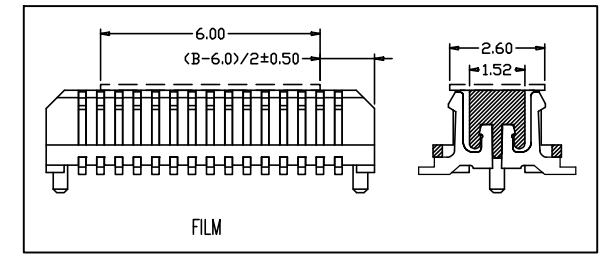
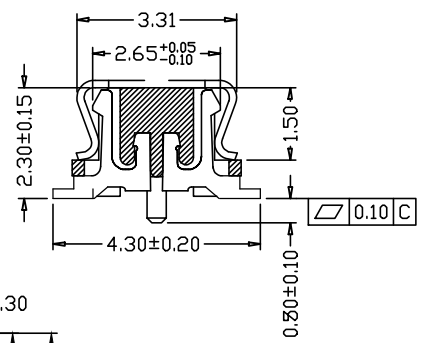

MATING DRAWING
MPAS4.MPAS6
(H=3.50mm)

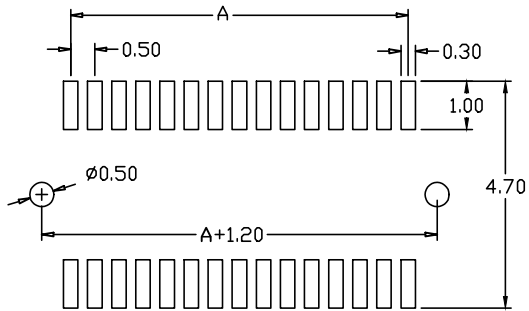

Recommended PCB Layout
(PCB TOLERANCE ±0.05)

APTOS Technology CONFIDENTIAL
This document, and all information it contains, are the confidential, proprietary property of APTOS Technology. Disclosure, duplication or distribution of this document, or any information it contains, in whole or part, without prior written permission from APTOS Technology is strictly prohibited

SPECIFICATIONS

Current Rating: 0.5 Amps AC/DC Max.
Insulator Resistance: 100 Megohms min.
Contact Resistance: 60m ohm Max.
Dielectric withstanding: AC 500V

MPAS4-XX XX X X-FG

S=Straight
NO. OF CONTACTS
PLATING
FG: RoHS Compliant
Packaging:
Null: Tube (w/o Film)
K:Reel(w/o Film)
C:Film&Reel
F:Film&Tube
E:MPAd&Tube
B:MPAd&Reel
0:w/o Locating Peg
1:With Locating Peg

Definition	Code
⊙ Tin plated:	VA
⊙ Gold plated:	
flash VB	10μ" VE
	15μ" VF
	30μ" VJ
⊙Standard: VB	

GENERAL TOLERANCE UNLESS OTHERWISE SPECIFIED	
XXX. ± X	.XX ± 0.10
XX. ± X	.XXX ± X
X. ± 0.50	X' ± 1'
.X ± 0.30	.X' ± X'



REV. A	DRAWN	09/15/09	MPAS4 Series
DATE 09/15/09	CHECKED		0.5mm Board to Board Plug
SCALE As shown	APPROVED		PRODUCT NO. MPAS4-XXXXXX-FG
UNIT mm		SIZE A4	FILE NAME MPAS4-XXXXXX-FG.dwg